



ZF in Compact Loaders

For the smaller articulated wheel loaders up to 11 tons empty vehicle weight, ZF offers a wide range of driveline solutions.

The very compact and modular design allows the optimal adaptation to the vehicle application and the customer requests.

AVG

- Acoustically optimized helical gearing
- Axle mounted solution for ZF MULTITRAC axles
- Remote mounting available
- Designed for a common hydrostatic drive concept

MULTITRAC

- High efficiency due to avoidance of braking losses and optimized oil supplies
- High ground clearance
- Less generation of heat due to cylindrical roller bearings



ZF Driveline Technology for Compact Loader

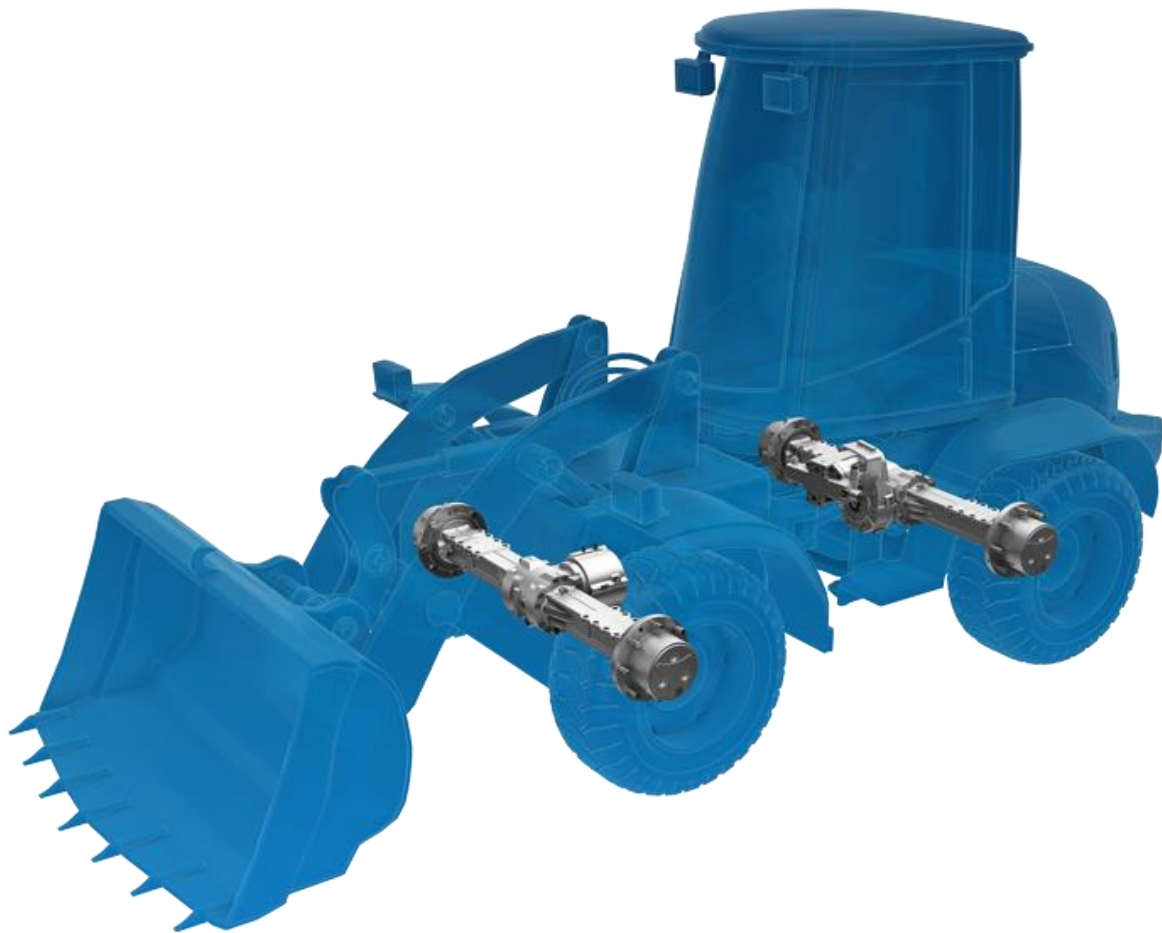

Product and performance classes

Empty vehicle weight ¹⁾	Front axle	Rear axle	Transmission
Class up to 3.9 t Class up to 8,600 lbs	MT-L 3010-II	MT-L 3010-II	1 AVG 150/185
Class up to 4.9 t Class up to 10,800 lbs	MT-L 3015-II	MT-L 3015-II	1 AVG 150/185
Class up to 5.8 t Class up to 12,700 lbs	MT-L 3020-II	MT-L 3020-II	1 AVG 150/185
Class up to 6.6 t Class up to 14,500 lbs	MT-L 3025-II	MT-L 3025-II	1 AVG 150/185
Class up to 9.8 t Class up to 21,600 lbs	MT-L 3045	MT-L 3045	1 AVG 185
Class up to 11.0 t Class up to 24,200 lbs	MT-L 3055	MT-L 3055	1 AVG 185

1) Empty vehicle weight without additional equipment