

# System Configuration Layout

## 4S/4M ABS/ATC/RSC

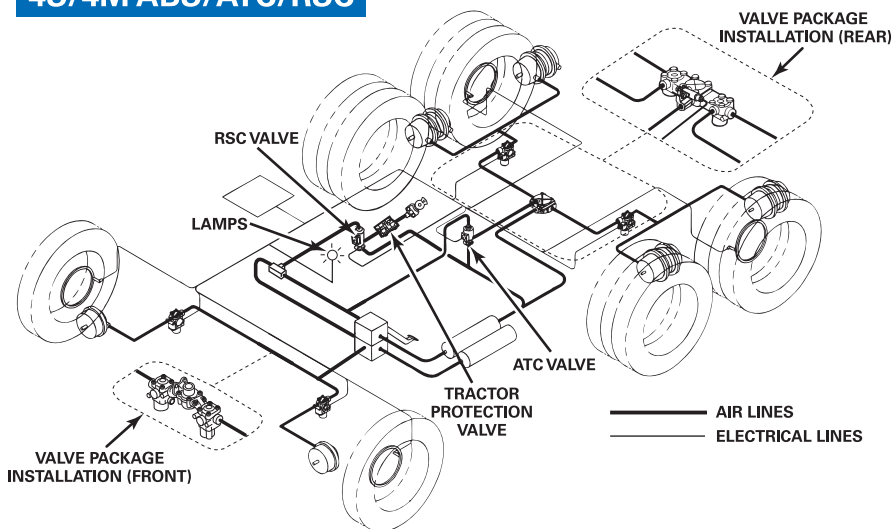

## ECU Identification

### D Version



Basic ECU

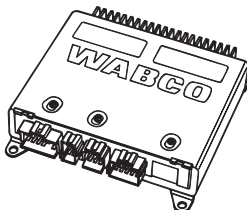

Cab-Mounted ECU

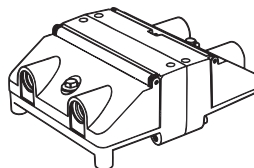

Frame-Mounted ECU

### E Version



Basic ECU

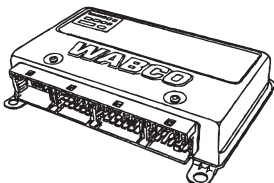

Universal ECU

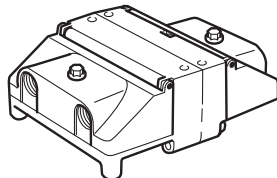

Frame-Mounted ECU

For further information, refer to Maintenance Manual 30 (D Version ABS) or Maintenance Manual 0112 (E Version ABS) or call:

**855-228-3203**

**WABCO**

# WABCO

## D and E Version ABS (12 volt) Blink Code Identification Guide

| 1st Digit | 2nd Digit | TROUBLESHOOTING AND REPAIR   |
|-----------|-----------|--|
| 1         | 1         | System O.K.  |
| 2         | 1-6*      | Check ABS modulator valve, valve cable and connectors. Verify 4.0-9.0 ohms resistance (ABS modulator valve).   |
| 3         | 1-6*      | Adjust wheel sensor to touch tooth wheel. Check sensor gap. Check for loose wheel bearings or excessive hub runout. Verify minimum 0.2 volts AC output @ 30 RPM.   |
| 4         | 1-6*      | Check sensor, sensor cable and connectors. Verify 900-2000 ohms resistance.  |
| 5         | 1-6*      | Check for tire size mismatch or tooth wheel difference. Check sensor, sensor cable and connector for intermittent contact.   |
| 6         | 1-6*      | Check for damaged tooth wheel.   |
| 7         | 1         | Check for correct J1939 and ESC (if so equipped) data link connection. Check if fault was caused on dynamometer. Check parameter setting regarding HSA switch and broadcast HSA switch information in EBC 5.                   |
| 7         | 2         | Check ATC valve, valve cables and connectors. Verify 7.0-14.0 ohms resistance.   |
| 7         | 3         | Check retarder (third brake) connections.  |
| 7         | 6         | Check RSC and Front Axle Active Brake Valves (ABV) and Stability Control Modulator (if so equipped). For ABV, verify 7.0-14.0 ohms resistance. For Stability Control Modulator, verify 4.0-9.0 ohms resistance.                |
| 7         | 7         | Check Brake Pressure Sensor. Verify sensor is getting 8.0-16.0 volts power and that there is continuity between sensor signal and ground or power. Check Brake Light Switch.   |
| 8         | 1         | Check vehicle voltage and supply to ECU (9.0-16.0 volts).  |
| 8         | 2         | Check vehicle voltage. Verify accuracy of blink code and clear from ECU memory.  |
| 8         | 3         | Verify accuracy of blink code and clear from ECU memory.   |
| 8         | 4         | Verify all ECU connectors are in place. Verify accuracy of blink code and clear from ECU memory. <i>If code does not clear, it may be necessary to reconfigure or replace the ECU.</i>   |
| 8         | 5         | <u>D Version:</u> Full function, cab-mounted only. Check all ABS valve ground connections for diagonals 1 and 2 (open, shorted to ground or shorted to battery).<br><u>E Version:</u> Check all ABS ECU and ATC valve grounds. |
| 8         | 6         | <u>E Version:</u> Verify accuracy of blink code and clear SAS from ECU memory. Contact WABCO North America Customer Care at 855-228-3203.  |

### INSTRUCTIONS

1. Hold 1 Second. Light is ON.

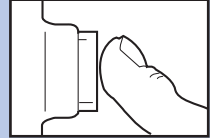

*Pause 1.5 Seconds*

2. Count Flashes for 1st Digit (1-8).



*Pause 1.5 Seconds*

3. Count Flashes for 2nd Digit (1-6).



*Pause 4 Seconds  
Repeat Code*

4. Match Blink Code left. Read Troubleshooting and Repair.

#### \* 1-6 Key

- |  |   |
|--|---|
| 1 Right front steer axle (curb side)               | 4 Left forward/rear tandem drive axle (driver's side) |
| 2 Left front steer axle (driver's side)            | 5 Right rear/rear tandem drive axle (curb side)       |
| 3 Right forward/rear tandem drive axle (curb side) | 6 Left rear/rear tandem drive axle (driver's side)    |